

**ADDED
VALUE!**

MUROX Canopy



Quick facts about MuroxCanopy

- *Simple and aesthetically pleasing*
- *Watertight*
- *Modular for easy and rapid installation*
- *16-gauge steel construction*
- *Complete with gutter*
- *Available in 5 and 10-foot-long modules (1.5 m and 3 m)*
- *Ideal for use above all types of doors*
- *Polyurethane primer and a two-coat acrylic urethane enamel paint finish for long-term durability*
- *Available in an assortment of colours*

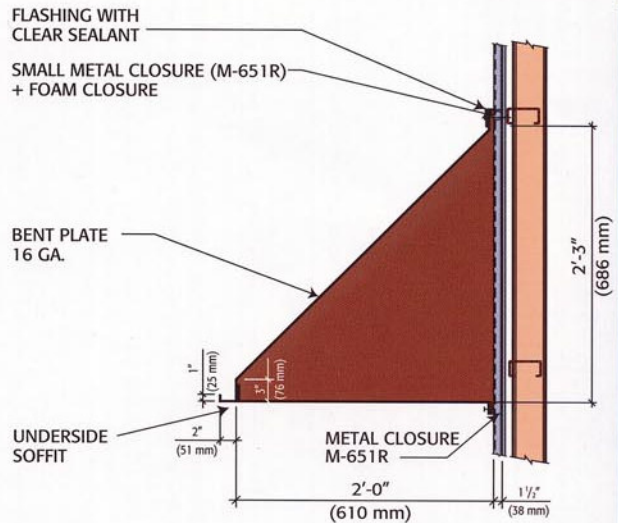

CANOPY SECTION

Murox provides High Performance™ load-bearing, panelized building systems to the non-residential construction market.